

PLAN SHOWING THE PROPOSED DWELLING HOUSE IN S NO: 343/3  
 PATTA NO: 1042, AT TI KONNUR VILLAGE, DIV. 32, VILLIVAKKAM,  
 MADRAS-49 OF SRI. K. THASARATHAN. SCALE 1"=8' 1CM=1M.

DOOR	D	3'3" x 7'0"	100 x 212
DOOR	D1	3'0" x 6'6"	91 x 197
DOOR	D2	2'6" x 6'6"	76 x 197
WINDOW	W	4'6" x 4'0"	137 x 122
WINDOW	W1	3'0" x 4'0"	91 x 122
VENTILATOR	V	3'0" x 2'0"	91 x 61
CUPBOARD	CB	3'0" x 6'0"	91 x 182

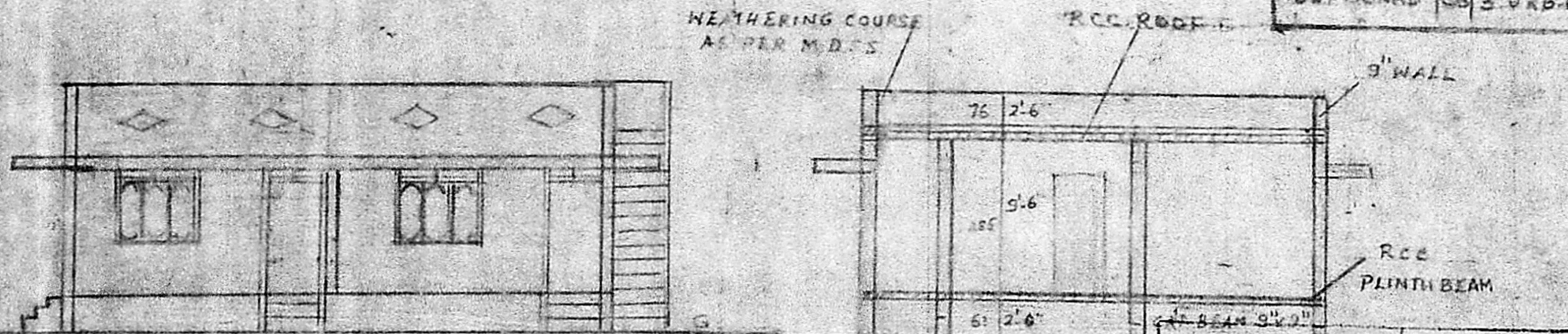
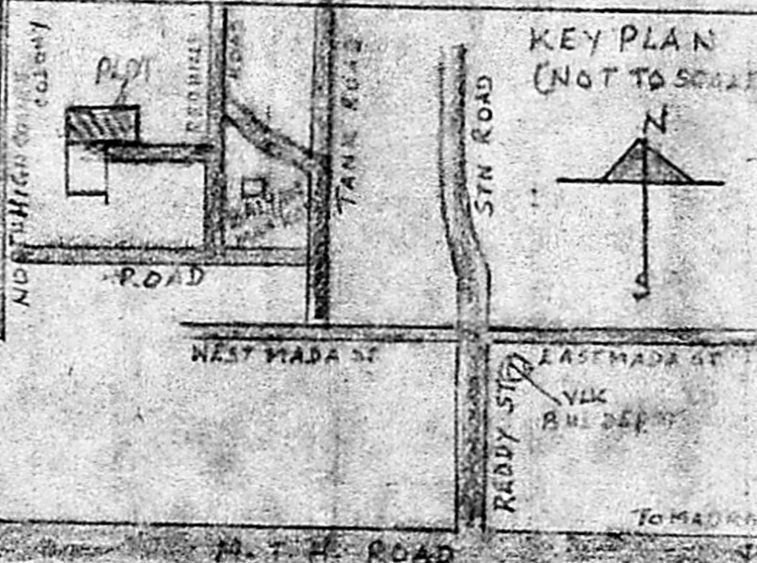

FOUNDATION TO BE OF RCC PILES 9" DIA 10' DEEP FROM G.L. AND CONNECTING BEAM AT 5' G.C.  
 BRICK WORK IN C.M. 1:6.  
 FLOORING WITH B.T.C. WITH LIME 1:4:8 AND TOP RENDERED IN C.M. 1:5, 3/4" THICK.  
 PLASTERING OF WALLS IN C.M. 1:5 AND CEILING IN C.M. 1:3, 1/2" THICK.  
 R.C.C. ROOF SLAB IN C.M. 1:2:4.  
 WOOD WORK ALL BEST COUNTRY WOOD.  
 WHITE WASHING OF 2 COATS & PAINTING OF 2 COATS.

MMDA (A)/PP NO. /  
 R.C.C. PILES 9" DIA 10' DEEP  
 A/2004/89  
 FASSA G.L. R.P. dt. 24.5.89  
 Part I  
 Part II  
 A.P. D.P.

Planning Permit No. A/466/89  
**APPROVED**  
 Subject to the conditions in this office letter.  
 No. A/2004/89 dt. 29-5-89.  
 FOR MEMBER SECRETARY  
 MADRAS METROPOLITAN DEVELOPMENT AUTHORITY

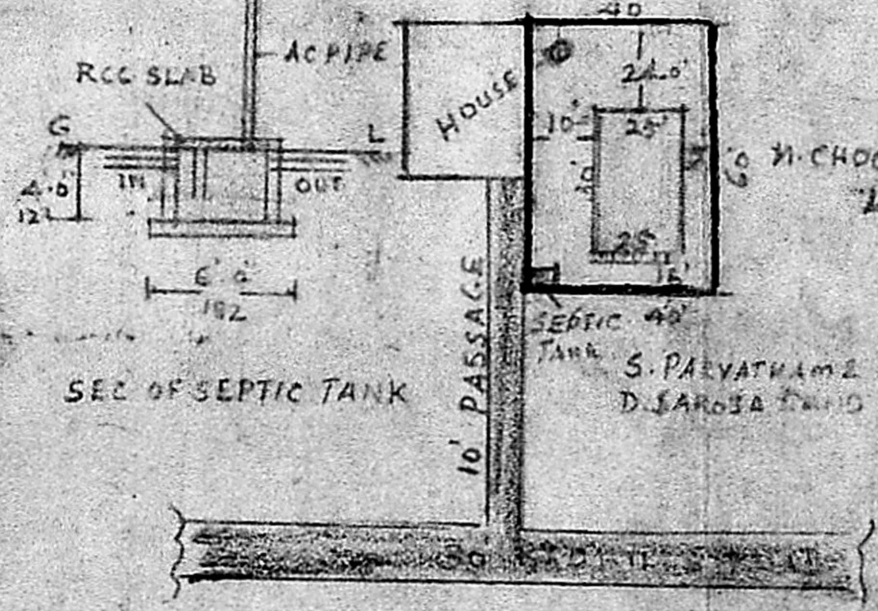
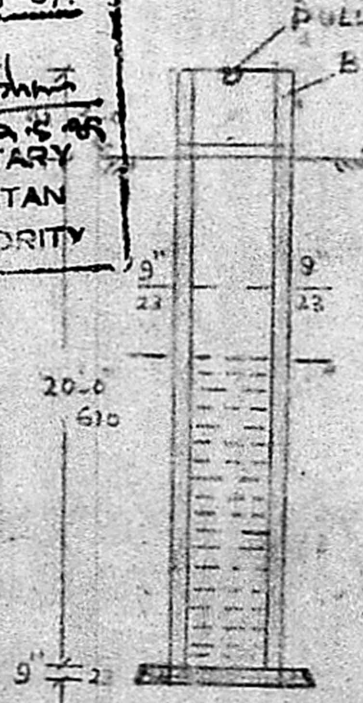
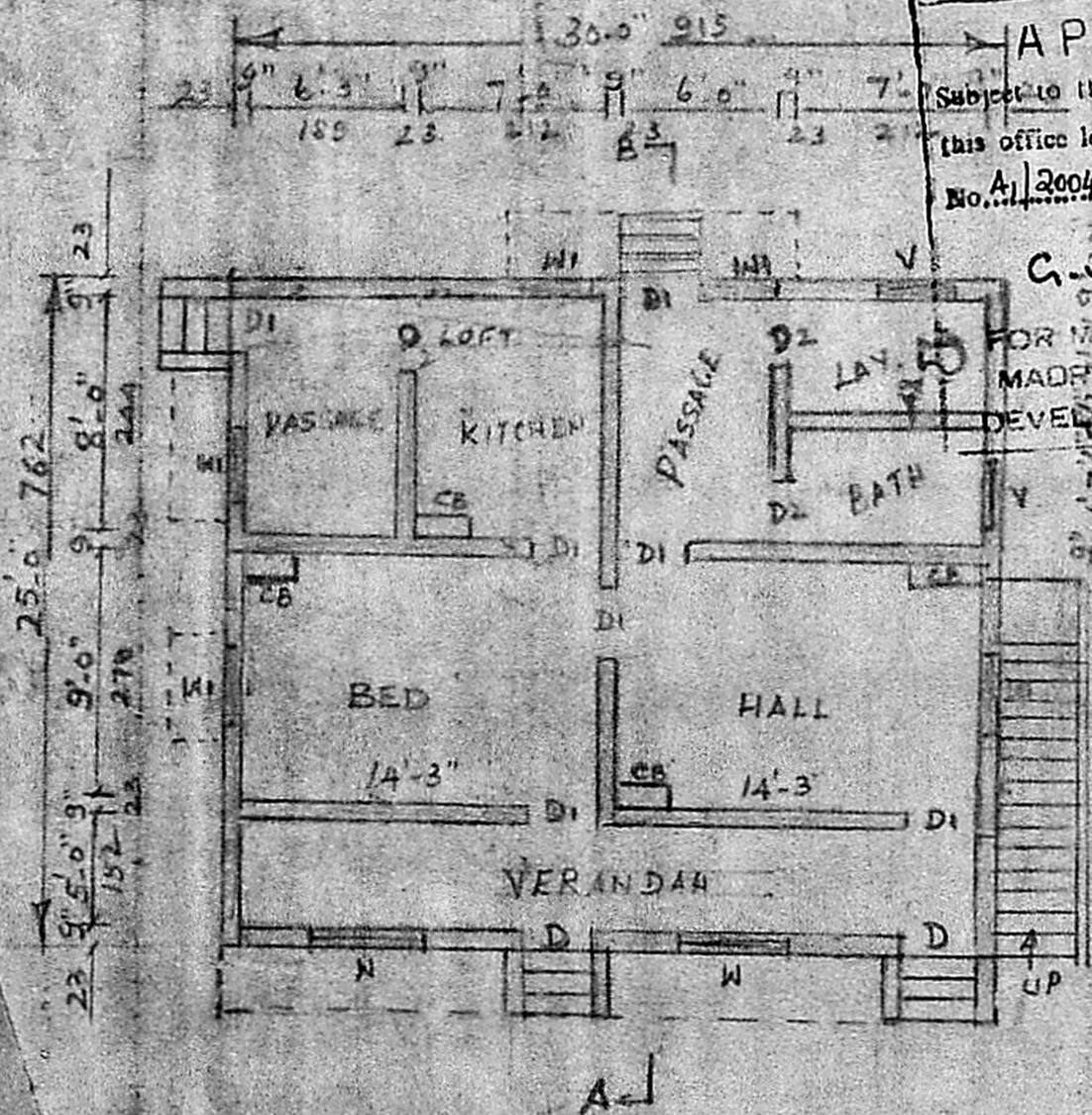

PROPOSED ROAD BOUNDRY  
 LAND AREA 2400 SQFT  
 PLINTH AREA 750 SQFT  
 CARPET AREA 645 SQFT

**G. VEDAGIRI, B.Eng.**  
 CIVIL ENGINEER,  
 LICENSED SURVEYOR  
 INSTR. II. No. 30  
 Corporation of Madras  
 No. 13, DEVAR STREET,  
 CHENNAI - 600 004  
 LICENSED SURVEYOR

K. Thasaratham  
 OWNER